

PARTS LIST		HI PRESSURE DEWATERING PUMP			2/8/2023	
ITEM	PART No.	DESCRIPTION	QTY	SIZE	MATERIAL	NOTES
1	141-004-20	Hex. Nut	2	M6	SUS316	
2	010-CLIP-LH311W-14	Cable Clip	1	For O.D. 22.4	SUS316	S4-02278-1
	010-000-00	Cable Clip Rubber	1	40x70x1t	VITON	N4-121452T
3	009-117-11	Terminal	3	R-22-6	CU	
4	009-107-18	Terminal	1	R-14-6	CU	
5	009-116-10	Terminal	2	R-2-4	CU	
6	140-035-27	Hex. Bolt	2	M6x20	SUS316	
7	011-000-07	Shackle	1	6mm(M8,SC)	SUS316	
8	095-000-00	Chain	1	d5(9-Link)	SUS316	N3-13381-2T
9	072-103-36	Eye Bolt	2	M24	SUS316	
	142-000-00	Washer for Eye Bolt		d44xd25x0.3t/0.5t	SUS316	N4-10881-4T
10	001-LH311W-14	Power Cable		4Cx8mm2+2C2mm2	2PNCT.F	
11	140-076-20	Hex.Bolt	2	M10x30	SUS316	
12						
13		Gland	1	LH311W-14	SCS14	S3-02072-1
14	004-LH311W-14	Cable Bush 60Hz (USA)	1	d23.5xd54x27L	CR	N4-10476-1T
	005-126-11	Bush Washer	2	d27xd54x3t	SUS316	
15	140-076-20	Hex. Bolt	4	M10x30	SUS316	
	142-164-22	Spring Washer	4	M10	SUS316	
16	006-107-19	Stuffing Box	1	110-CL	SCS14	
17	122-135-22	O-Ring	1	G-120(119.4xd3.1)	FKM	*
18		no parts				
19		no parts				
20		no parts				
21	009-129-16	Terminal	4	E (Small)	CU	
	009-101-12	Terminal(C/W Screw)	4	d12x(d6.6xd6.6)x25l	C3604	
22	009-129-16	Terminal	4	E (Small)	CU	
23		no parts				
24	002-135-14	Heat Shrink Tube (Sold per meter)	m	A(d15x0.3t)	(Vm)	
25	002-132-11	Heat Shrink Tube (Sold per meter)	m	A4(d17x0.27t)	(Vm)	
26	009-114-18	Connector	2	PC-4020M		
27	009-107-18	Terminal	1	R-14-6	CU	
	009-296-15	Grounding Wire	1Set	8mm2x180L		
28	140-001-41	Hex. Bolt	1	M6x10	SUS316	
	142-162-20	Spring Washer	1	M6	SUS316	
	142-142-37	Plain Washer	1	M6	SUS316	
29	009-115-19	Connector	2	PC-4020F		
30		no parts				
31	002-164-12	Heat Shrink Tube (Sold per meter)	m	A4(d13x0.3t)	(Vm)	

PARTS LIST		HI PRESSURE DEWATERING PUMP			2/8/2023	
ITEM	PART No.	DESCRIPTION	QTY	SIZE	MATERIAL	NOTES
32	141-007-23	Hex. Nut	8	M12	SUS316	
33	142-165-23	Spring Washer	8	M12	SUS316	
34	144-001-11	Stud Bolt	8	M12x40L(22/24)	SUS316	
35	037-LH311W-14	Flanged Discharge Pipe	1	JIS10K, 80mm, PCD125	SUS316	N2-10436-3T
36	121-447-14	Packing	1	d78xd152x1t	THREE SHEET	*
37	140-134-27	Hex. Bolt	4	M16x90	SUS316	
38	142-166-24	Spring Washer	4	M16	SUS316	
	142-001-21	Plain Washer	4	d16.5xd33.5x5t	SUS316	
39	121-001-95	Seal Washer	4	d15.5xd27d4t	FKM	*
40	051-000-70	Motor Head Cover	1	MJA6139Z,LH311/322W-14	SCS14	
41	122-147-27	O-Ring	1	G-180(179.3xd5.7)	FKM	*
42	140-001-42	Pan Screw	2	M5x10	SUS316	
43	214-006-18	Blind Cover	1	d100x1.6t	SPHC	
44	016-114-10	Lead Wire Protection Bush	1	GH-637/837(for 5 cores)	SBR	
45	016-113-19	Lead Wire Protection Bush	1	GH-422/430(for 3 cores)	SBR	
46	140-100-24	Hex. Bolt	6	M12x45	SUS316	
47	142-165-23	Spring Washer	6	M12	SUS316	
48	050-001-34	Motor Bracket	1	MJA6139Z,LH311/322W-14	SCS14	
49A	142-199-13	Wave Washer	1	6208/6307	SK5	
49	052-203-19	Bearing	1	6307ZZC3		
49B	122-127-18	O-Ring	1	G-80(79.4xd3.1)	NBR	*
50	121-001-96	Packing	2	LH322W-14	FKM	*
51	065-LH11.22W-14	Outer Cover	1	MJA6139Z,LH311/322W-14	SUS316	
52	055-LW311W-14	Rotor	1Set			
53	147-000-78	Impeller Key	2	10x8x25L	SUS316	
54	056-460V-LH311W-14	Stator 460V-60Hz(USA)	1Set			
	053-309-19	Miniature Protector	3	9700K-46-215		
55	122-153-26	O-Ring	1	G-220(219.3xd5.7)	FKM	*
56	064-001-50	Motor Frame	1	MJA6139Z,LH311/322W-14	SCS14	
57	122-259-23	O-Ring	1	12xd3	FKM	*
58	144-000-00	Stator Set Bolt	1	M12(B=21)	SUS316	
59	122-000-90	O-Ring	1	V-150(148.5xd4)	FKM	*
60	122-000-91	O-Ring	1	G-195(184.3xd5.7)	FKM	*
61	121-463-16	Packing (Felt)	2	4x4.4x217l	Felt	
62	140-055-36	Hex. Bolt	4	M8x25	SUS316	
63	062-210-10	Bearing Cover	1	d55.5xd160x22t	FC	
64	052-120-11	Bearing	1Set	7311ADBC3		
65	142-244-14	Bearing Washer	1	AW11	SPCC	
66	141-076-10	Bearing Nut	1	AN11	SS	

PARTS LIST		HI PRESSURE DEWATERING PUMP			2/8/2023	
ITEM	PART No.	DESCRIPTION	QTY	SIZE	MATERIAL	NOTES
67	026-272-18	Oil Seal	1	SC-50689	NBR	
68	060-001-99	Bearing Housing	1	MJA6139Z,LH311/322W-14	SCS14	Serial# 1653247-001/002 use OLD bearing housing;
69	121-395-16	Packing	3	d11.8xd18x3t	PE	*
70	035-LH311W-14	Oil Plug	3	M12x14	SUS316	N4-00726-2T
71	142-165-23	Spring Washer	6	M12	SUS316	
71a	142-298-13	Seal Washer	6	SM-12	SUS+NBR	
72	140-100-24	Hex. Bolt	6	M12x45	SUS316	
73	122-127-18	O-Ring	1	G-80(79.4xd3.1)	NBR	*
74	028-000-27	Seal Housing	1	LH322W/430W-51/61	FC	order this when replacing #68 Bearing Housing
75	121-395-16	Packing	3	d11.8xd18x3t	PE	*
76	035-LH311W-14	Oil Plug	1	M12x14	SUS316	N4-00726-2T
77	142-163-21	Spring Washer	4	M8	SUS316	
78	140-055-36	Hex. Bolt	4	M8x25	SUS316	
79	004-000-00	Cable Bush	1	LH322W/430W-51/61	FKM	
80	003-207-11	Gland	1	LH322W/430W-51/61	SUS316	
81	142-161-29	Spring Washer	2	M5	SUS316	
82	140-019-25	Hex. Bolt	2	M5x16	SUS316	
83	025-001-29	Mechanical Seal	1	HT-4550N	SIC, FKM	
84	143-070-23	Pan Screw	2	M5x6	SWRM	
85	030-136-12	Oil Lifter	1	HT-4550	Resin	
86	143-070-10	Pan Screw	6	M5x6	SWRM	
87	030-145-14	Seal Stopper	1	HT-4550	SPCC	
88	122-251-12	O-Ring	1	205xd3.8	NBR	*
89	029-LH11.22W-14	Oil Casing	1	LH322W/430W	SCS14	S2-04126-1
90	142-164-22	Spring Washer	4	M10	SUS316	
91	140-000-90	Hex. Socket Cap Bolt	4	M10x30	SUS316	
92	071-000-69	Shaft Sleeve (Upper)	1	d40xd50x23t	SUS316	N4-010382-1T
93	144-001-12	Stud Bolt	4	M16x55(28/24)(JIS)	SUS316	
94	122-000-92	O-Ring	4	P-16(15.8xd2.4)	FKM	*
95	122-000-93	O-Ring	1	205xd3.8	FKM	*
96	122-000-94	O-Ring	1	310xd3.8	FKM	*
97	020-U-LH311W-14	Pump Casing (Upper)	1	LH311W-14(w/Labyrinth Ring)	SCS14	S1-00681-1
98	142-166-24	Spring Washer	4	M16	SUS316	
99	141-008-24	Hex. Nut	4	M16	SUS316	
100	140-125-25	Hex. Bolt	4	M16x45	SUS316	
101	142-166-24	Spring Washer	4	M16	SUS316	
102	122-000-94	O-Ring	1	310xd3.8	FKM	*
103	040-LH11.22W-14	Impeller Shim		d41.5xd59x0.2t/0.3t	SUS316	N3-12180-5T
104	021-LH311W-14	Impeller (60Hz)	2	LH311W-14	SCS14	S2-04386-1

* Indicates items included in set

PARTS LIST		HI PRESSURE DEWATERING PUMP			2/8/2023	
ITEM	PART No.	DESCRIPTION	QTY	SIZE	MATERIAL	NOTES
105	020-M-LH311W-14	Pump Casing (Middle)	1	LH311W-14(w/Labyrinth Ring)	SCS14	S1-00682-1
106	122-000-94	O-Ring	1	310xd3.8	FKM	*
107	071-000-70	Shaft Sleeve (Lower)	1	d40xd50x47t	SUS316	N4-010383-1T
108	142-001-22	Nord-Lock Washer	1	M30	SUS316	
109	141-000-26	Hex. Nut	1	M30, LH311/322W-14	SUS316	N4-00233-1T
110	020-L-LH311W-14	Pump Casing (Lower)	1	LH311W-14	SCS14	S1-00683-1
111	142-166-24	Spring Washer	4	M16	SUS316	
112	140-126-26	Hex. Bolt	4	M16x50	SUS316	
113	141-007-23	Hex. Nut	2	M12	SUS316	
114	142-165-23	Spring Washer	2	M12	SUS316	
115	142-129-38	Plain Washer	2	M12	SUS316	
116	043-102-19	Cathodic Protection Plate	2	AB-1HS(75x70x20t)	Al	
117	140-096-26	Hex. Bolt	2	M12x25	SUS316	
118	144-001-13	Stud Bolt	4	M16x111(24.5/24.5)	SUS316	
119	023-002-05	Strainer Stand	1	LH311/322W-14	SUS316	
120	142-166-24	Spring Washer	4	M16	SUS316	
121	141-008-24	Hex. Nut	4	M16	SUS316	
		NPT Flange Version				
	048-000-55	Companion Flange 3" NPT	1	JIS10K x NPT3"	SCS14	
	121-105-20	Gasket (Companion Flange)	1	JIS10K x 80mm	VITON	
	140-129-29	Hex. Bolt	8	M16x65	SUS316	
	141-008-24	Hex. Nut	8	M16	SUS316	
	142-166-24	Spring Washer	8	M16	SUS316	
	173-LH311W-14	Packing O-Ring Set	1Set	(Marked by *)		
17	122-135-22	O-Ring (S.Box)	1	G-120(119.4xd3.1)	FKM	*
36	121-447-14	Packing (Discharge Pipe)	1	d78xd152x1t	THREE SHEET	*
39	121-001-95	Seal Washer (Motor Head Cover bolt)	4	d15.5xd27d4t	FKM	*
41	122-147-27	O-Ring (Head Cover/M.Bracket)	1	G-180(179.3xd5.7)	FKM	*
49B	122-127-18	O-Ring (Upp. Bearing)	1	G-80(79.4xd3.1)	NBR	*
50	121-001-96	Packing (M.Bracket/Out.Cover)	1	d291xd307.8x16.4t	FKM	*
50	121-001-96	Packing (Out.Cover/Brg.Housing)	1	d291xd307.8x16.4t	FKM	*
55	122-153-26	O-Ring (M.Bracket/M.Frame)	1	G-220(219.3xd5.7)	FKM	*
57	122-259-23	O-Ring (Stator Set Bolt)	1	12xd3	FKM	*
59	122-000-90	O-Ring (M.Frame/Brg.Housing)	1	V-150(148.5xd4)	FKM	*
60	122-000-91	O-Ring (M.Frame/Brg.Housing)	1	G-195(184.3xd5.7)	FKM	*
69	121-395-16	Packing (Oil Plug)	3	d11.8xd18x3t	PE	*
73	122-127-18	O-Ring (Brg.Housing/Seal Housing)	1	G-80(79.4xd3.1)	NBR	*
75	121-395-16	Packing (Air Tightness Test Plug)	1	d11.8xd18x3t	PE	*
88	122-251-12	O-Ring (Brg.Housing/O.Casing)	1	205xd3.8	NBR	*



MODEL **LH311W-14-60**

PARTS LIST		HI PRESSURE DEWATERING PUMP				2/8/2023
ITEM	PART No.	DESCRIPTION	QTY	SIZE	MATERIAL	NOTES
94	122-000-92	O-Ring (Upp. P.Casing Bolt)	4	P-16(15.8xd2.4)	FKM	*
95	122-000-93	O-Ring (O.Casing/Upp. P.Casing)	1	205xd3.8	FKM	*
96	122-000-94	O-Ring (Brg.Housing/Upp. P.Casing)	1	310xd3.8	FKM	*
102	122-000-94	O-Ring (Upp./Mid. P.Casing)	1	310xd3.8	FKM	*
106	122-000-94	O-Ring (Mid./Low. P.Casing)	1	310xd3.8	FKM	*
		Lubricant		Turbine Oil VG32 2,200ml		

PARTS LIST		HI PRESSURE DEWATERING PUMP			2/8/2023	
ITEM	PART No.	DESCRIPTION	QTY	SIZE	MATERIAL	NOTES

EXPLODED VIEW LH311W-14-60

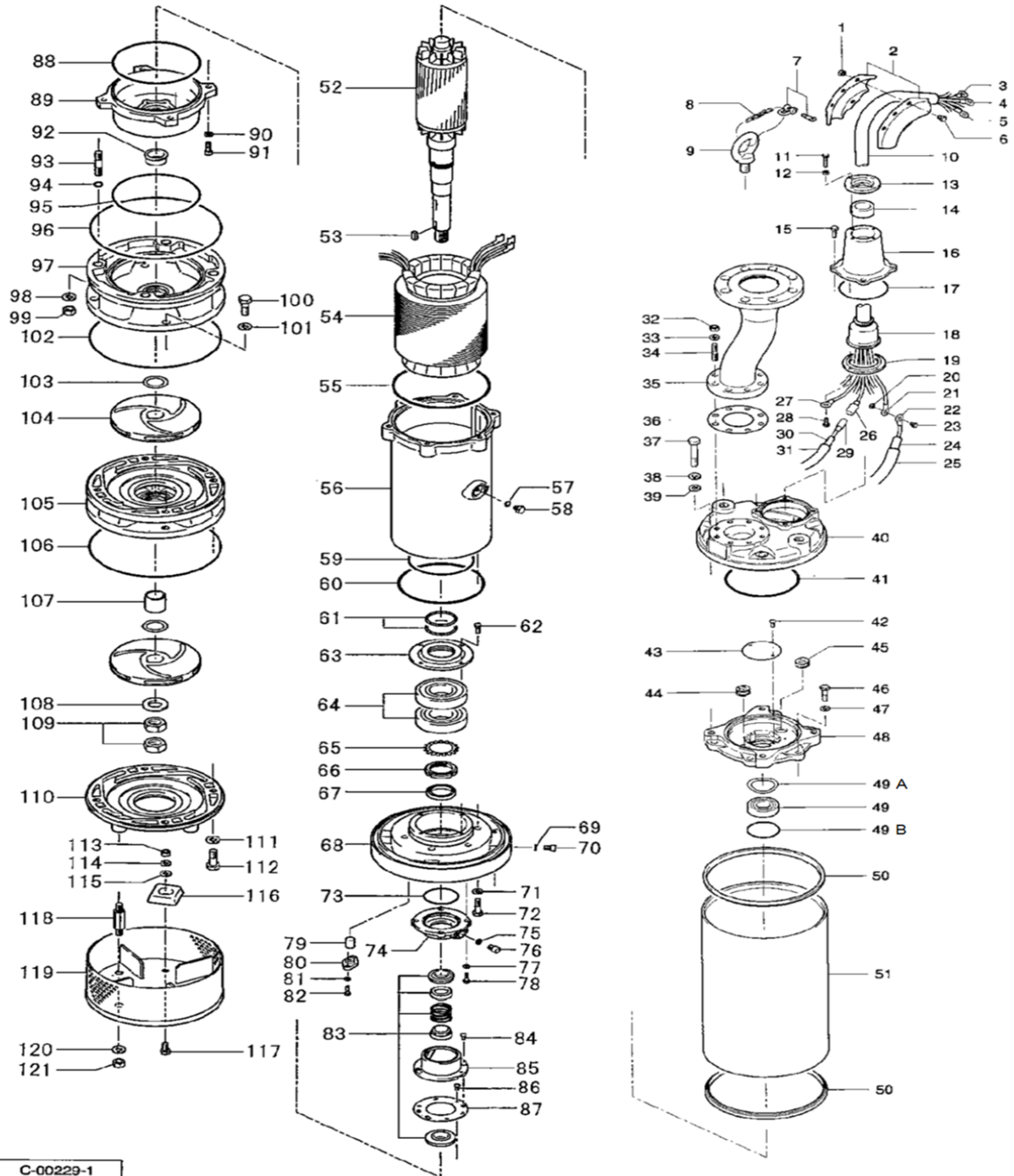

PARTS LIST		HI PRESSURE DEWATERING PUMP			2/8/2023	
ITEM	PART No.	DESCRIPTION	QTY	SIZE	MATERIAL	NOTES

For LH311W-14-60 and LH322W-14-61
 The precautions for replacement of the bearing housing are as follows.

There are two types of bearing housings depending on the time of production.
 These difference is the presence or absence of a hole. Old one has a gland and bush, but new one does not.

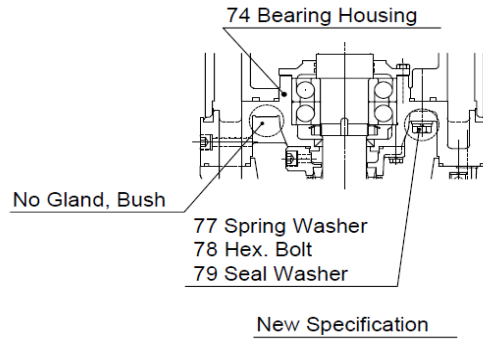
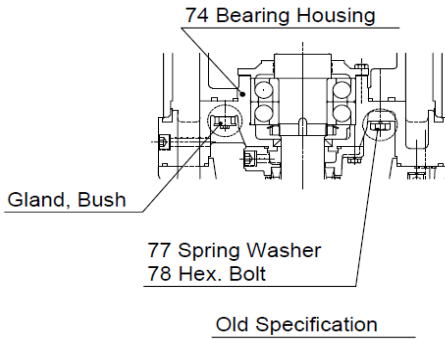

Please be sure to use "No.79 seal washer" to tighten the bolts when replacing the bearing housing.
 This is required for any bearing housing.