



BZ - SERIES

SINGLE VANE - SEWAGE & WASTE WATER PUMPS

SPECIFICATIONS

■ FEATURES

1. Single Vane, Cast Iron, impeller passes 3" diameter solids without clogging providing for highly efficient pumping of raw sewage and waste water.
2. Double inside mechanical seals with silicon carbide faces, running in an oil filled chamber and further protected by a lip seal, provides for the most durable seal design available.
3. Highly efficient, continuous duty, air filled, copper wound motor with class F, insulation minimizes the cost of operation.
4. Built in thermal & amperage sensing, protector prevents motor failure due to overloading, single phasing (in three phase units), or accidental run -dry conditions.
5. Double shielded, permanently lubricated, high temperature C3 ball bearings rated for a B-10 life of 60,000 hours, extend operational life.

■ APPLICATIONS

1. Residential, commercial, industrial sewage, effluent, wastewater and site drainage.
2. Decorative waterfalls, fountains and fish ponds.
3. Raw water supply from rivers or lakes.



■ SPECIFICATIONS

Discharge Size
 Horsepower Range
 Performance Range Capacity
 Head
 Maximum water temperature
 Materials of Construction
 Casing
 Impeller
 Shaft
 Motor Frame
 Fasteners

 Mechanical Seal
 Elastomers

 Impeller Type
 Solids Handling Capability

 Bearings

 Motor Nomenclature
 Type, Speed, Hz.
 Voltage, Phase

 Insulation

 Accessories
 Operational Mode

■ STANDARD

4" Npt (100 mm)
 2 ~15 Hp. (1.5 ~ 11 kW)
 105.7 ~ 951.0 Gpm. (.40 ~ 3.60 m³/min)
 21.0 Ft. ~ 101.7Ft. (6.4 ~ 31.0 m)
 104° F. (40° C.)

 ASTM 48 Class 35 Cast Iron
 ASTM 48 Class 35 Cast Iron
 420,403 Stainless Steel
 ASTM 48 Class 35 Cast Iron
 304 Stainless Steel

 Silicon Carbide
 NBR (Nitril Buna Rubber)

 Enclosed Single Vane, solids handling.
 3.15" (80 mm)

 Pre-lubricated, Double Shielded

 Air Filled, 1800 Rpm, 60 Hz.
 208-230, 230 or 440, 460 or 575 V.
 (3 Phase)

 Class F
 Submersible Power Cable 32' (10 m)
 Manual

■ OPTIONS

Nema 3R inverter available for
 230 V., 1 Ph. operation from
 2~5 Hp.

 Length as Required

 Model
 TOS Slide rail system

GROUP PERFORMANCE RANGE

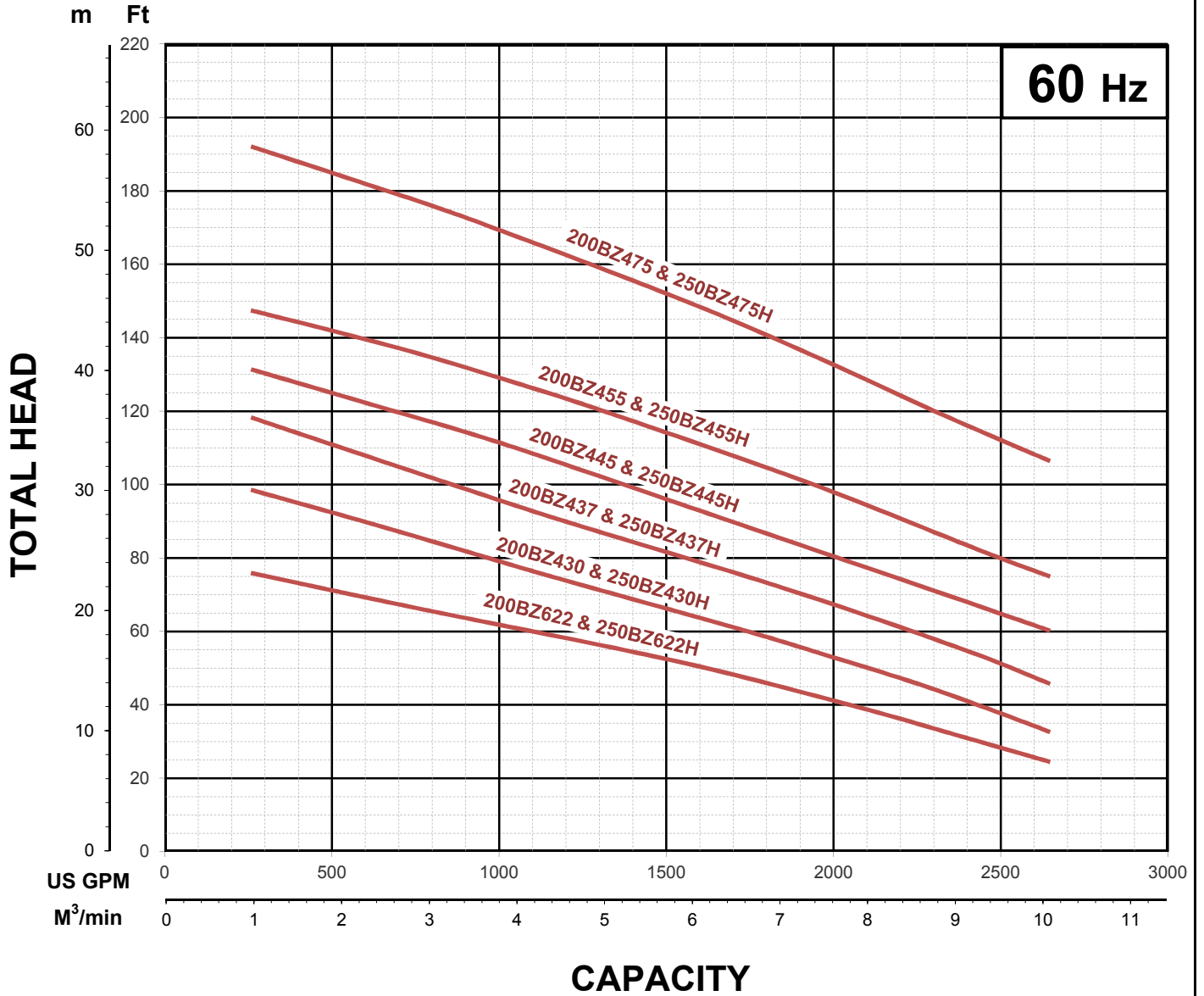

Note



BZ - SERIES

SEWAGE & WASTEWATER PUMPS

PERFORMANCE CURVE

MODEL		BORE	HP	kW	RPM	SOLIDS DIA.	LIQUID	SG.	VISCOSITY	TEMP.
(TO)200BZ445 -61		8"/200mm	60	45	SS 1800	3"/76.2mm	Water	1.0	1.123cSt.	60°F
PUMP TYPE		PHASE	VOLTAGE		AMPERAGE		HZ	STARTING METHOD		INS. CLASS
Sewage & Wastewater Pump		3	460 / 575		- / -		60	Star-Delta		F
CURVE No.	DATE	PHASE	VOLTAGE	AMPERAGE	HZ	STARTING METHOD		INS. CLASS		
-	-	-	-	-	-	-		-		

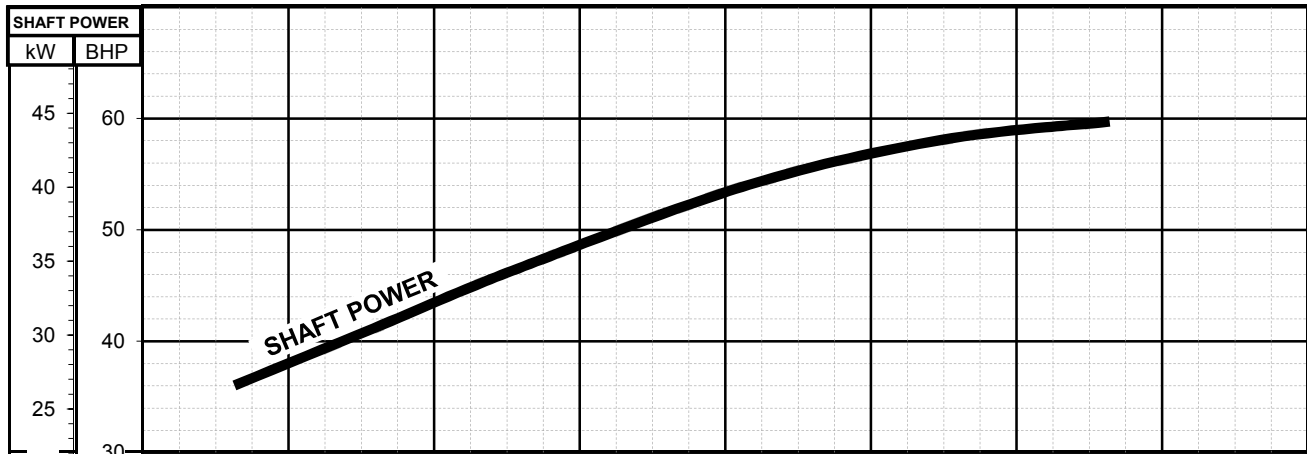
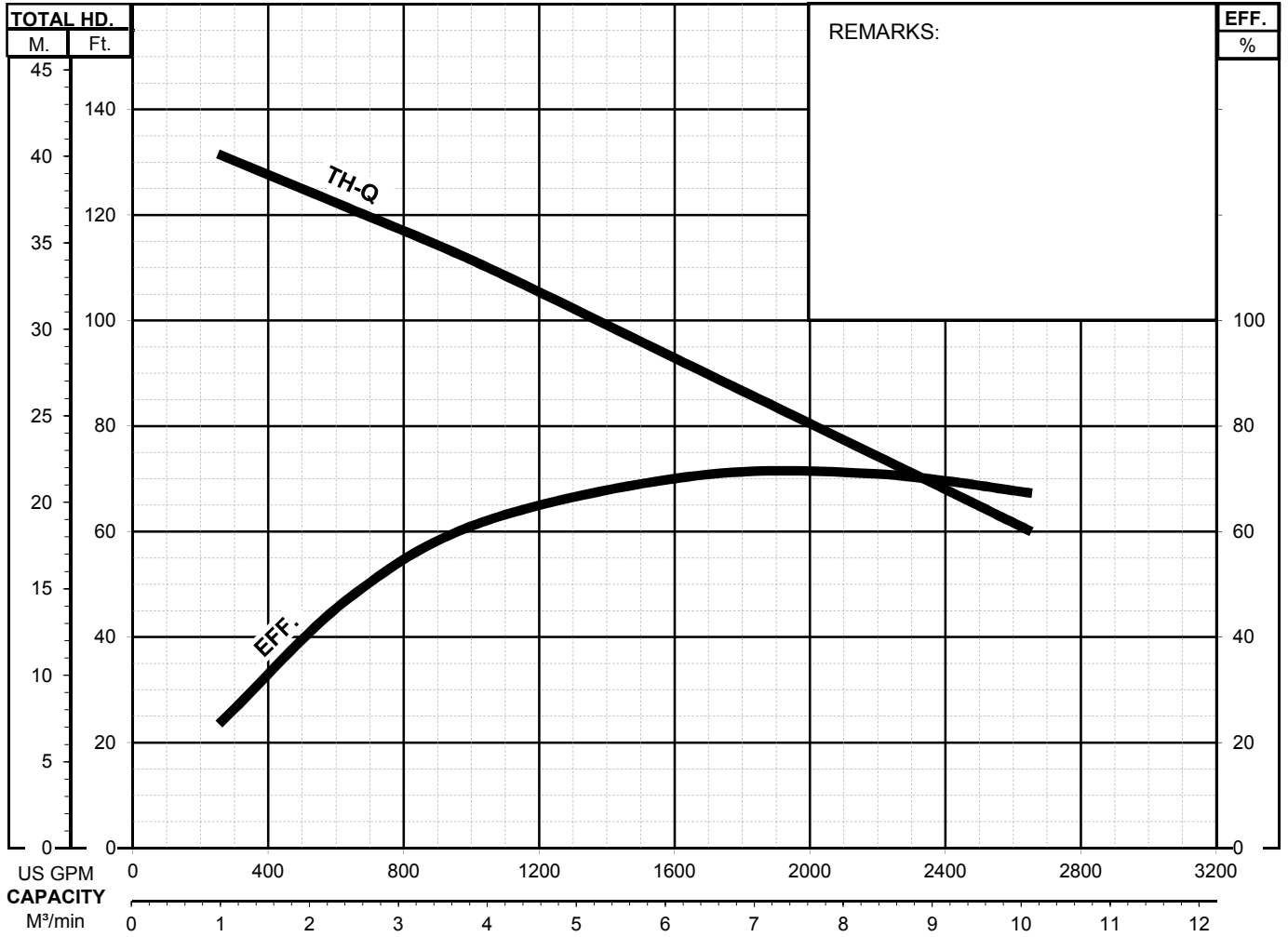

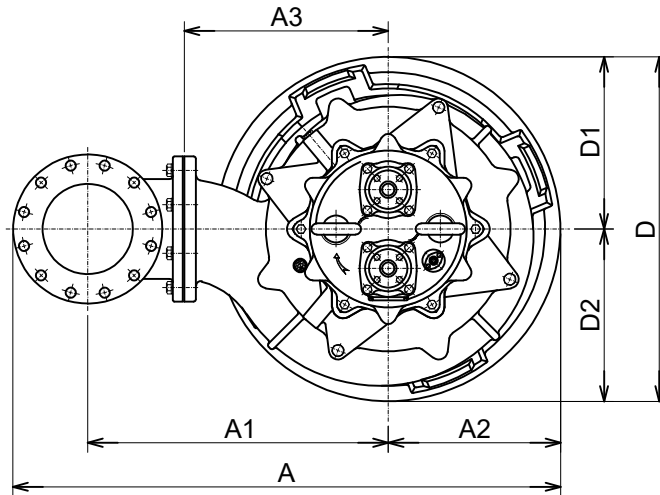

**200BZ622 -61
200BZ437 -61
200BZ445 -61**

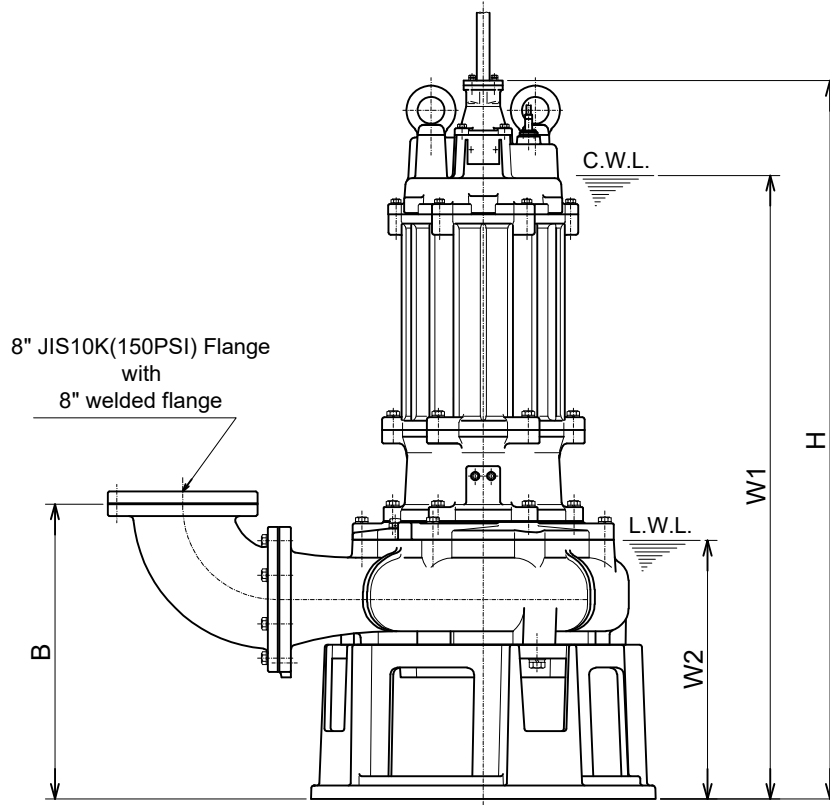

C.W.L. :Continuous running Water Level
L.W.L. :Lowest running Water Level

DIMENSIONS:USCS (Inch)

Model	HP	NOM. SIZE	Pump & Motor									C.W.L.	L.W.L.	*Wt. (lbs.)
			A	A1	A2	A3	B	D	D1	D2	H			
200BZ622-61	30	8"	47 9/16	26 1/8	14 15/16	17 11/16	25 9/16	29 15/16	14 15/16	14 15/16	62 3/8	54 1/8	22 1/2	1680
200BZ437-61	50	8"	47 9/16	26 1/8	14 15/16	17 11/16	25 9/16	29 15/16	14 15/16	14 15/16	61 7/8	53 3/4	22 1/2	1830
200BZ445-61	60	8"	47 9/16	26 1/8	14 15/16	17 11/16	25 9/16	29 15/16	14 15/16	14 15/16	62 3/8	54 1/8	22 1/2	1850

DIMENSIONS:METRIC (mm)

*Excluding Cable

Model	kW	NOM. SIZE	Pump & Motor									C.W.L.	L.W.L.	*Wt. (kg)
			A	A1	A2	A3	B	D	D1	D2	H			
200BZ622-61	22	200	1208	663	380	450	650	760	380	380	1584	1375	570	760
200BZ437-61	37	200	1208	663	380	450	650	760	380	380	1572	1365	570	830
200BZ445-61	45	200	1208	663	380	450	650	760	380	380	1584	1375	570	840

**TO200BZ622 -61
TO200BZ437 -61
TO200BZ445 -61**

**Guide rail
Model: TO-200
Weight: 198 lbs. (90kg)**

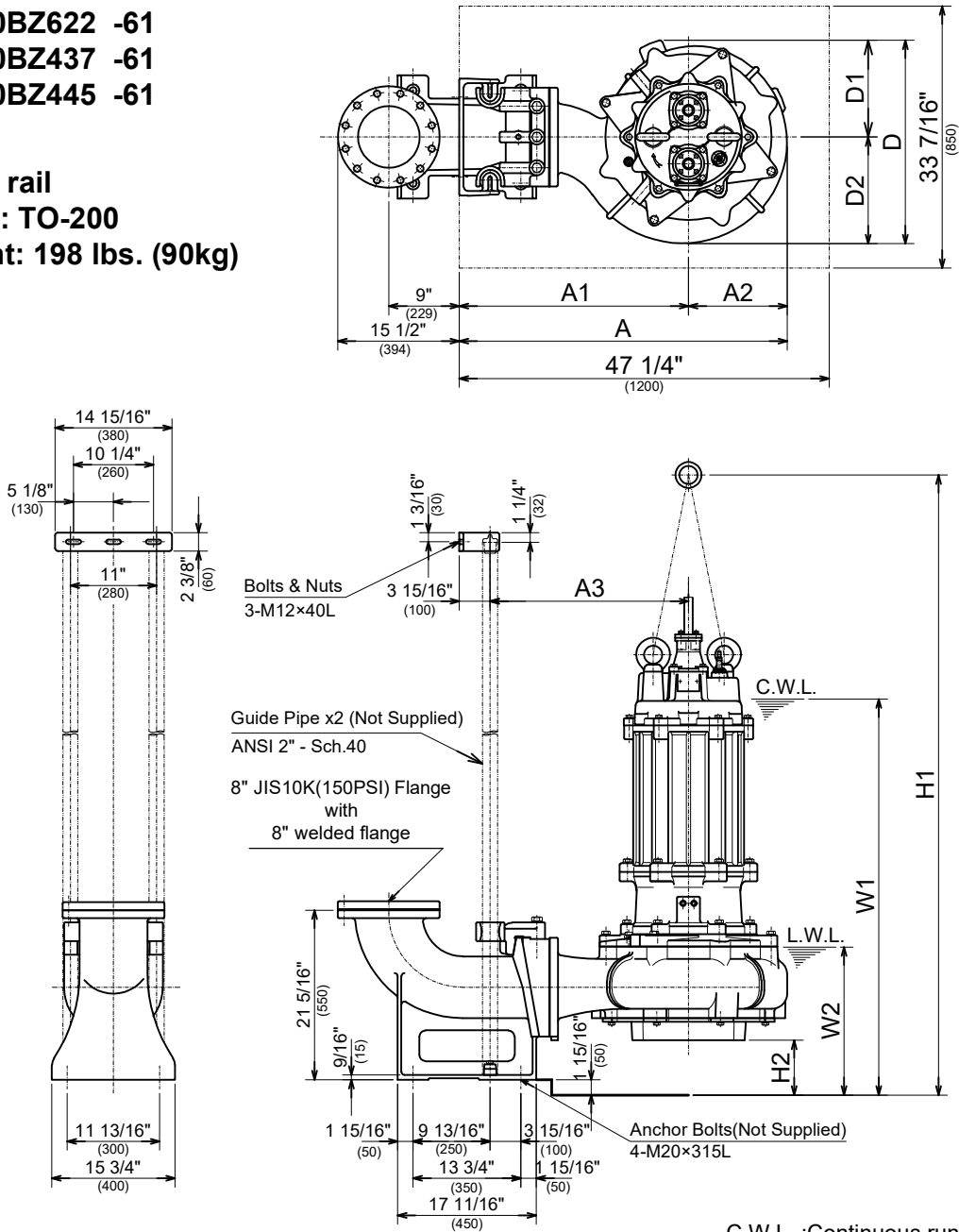

C.W.L. :Continuous running Water Level
L.W.L. :Lowest running Water Level

DIMENSIONS:USCS (Inch)

Model	HP	NOM. SIZE	Pump & Motor										C.W.L.	L.W.L.	*Wt. (lbs.)
			A	A1	A2	A3	D	D1	D2	H	H1	H2			
TO200BZ622 -61	30	8"	41 15/16	29 5/16	12 5/8	25 3/8	26	12 3/8	13 5/8	58 13/16	79 3/16	7	50 5/8	18 7/8	1570
TO200BZ437 -61	50	8"	41 15/16	29 5/16	12 5/8	25 3/8	26	12 3/8	13 5/8	58 3/8	78 3/4	7	50 1/4	18 7/8	1720
TO200BZ445 -61	60	8"	41 15/16	29 5/16	12 5/8	25 3/8	26	12 3/8	13 5/8	58 13/16	79 3/16	7	50 5/8	18 7/8	1740

DIMENSIONS:METRIC (mm)

Model	kW	NOM. SIZE	Pump & Motor										C.W.L.	L.W.L.	*Wt. (kg)
			A	A1	A2	A3	D	D1	D2	H	H1	H2			
TO200BZ622 -61	22	200	1065	744	321	644	660	314	346	1494	2012	178	1285	480	710
TO200BZ437 -61	37	200	1065	744	321	644	660	314	346	1482	2000	178	1275	480	780
TO200BZ445 -61	45	200	1065	744	321	644	660	314	346	1494	2012	178	1285	480	790

*Excluding TOS & Cable

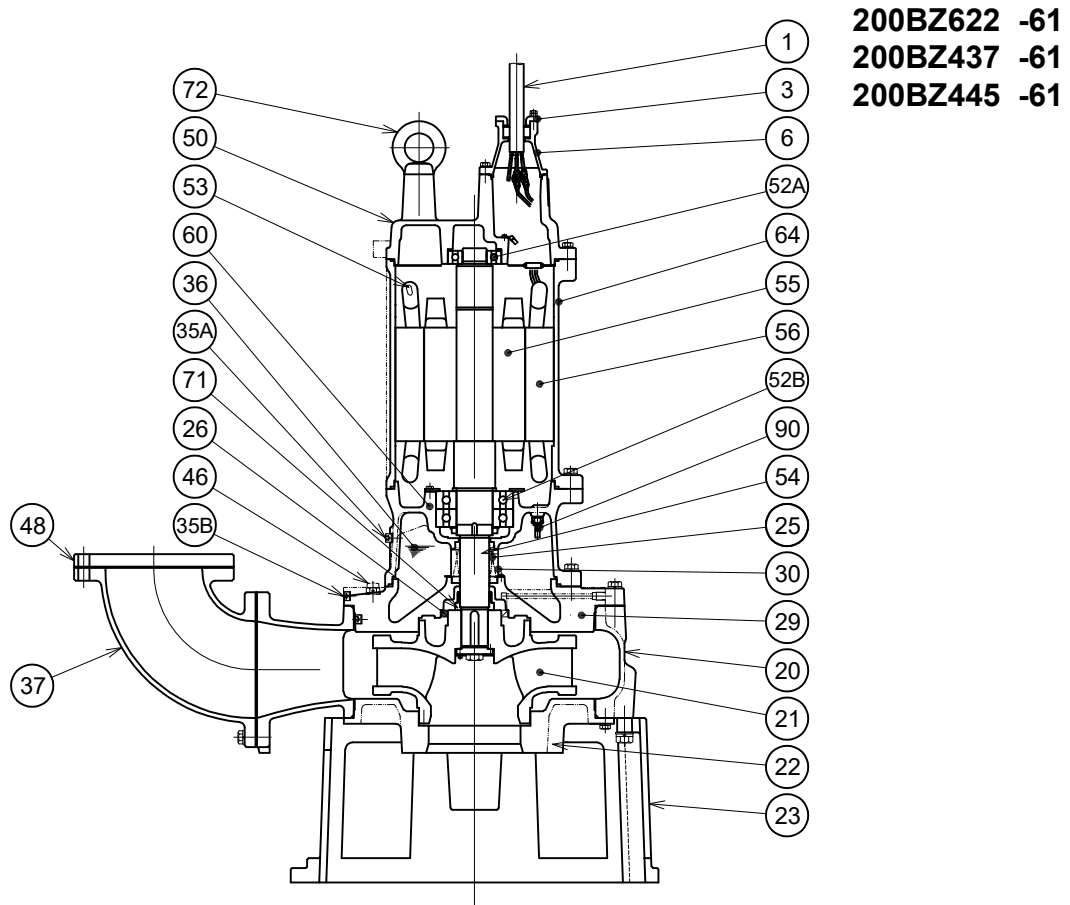

PART#	DESCRIPTION	MAIN MATERIAL / NOTE	RELATED ASTM, AISI CODE	RELATED EN CODE	QTY
1	Power Cable	Chloroprene Sheath AWG 6/4 - 32ft			1
	Power Cable	Chloroprene Sheath AWG 6/3 - 32ft			1
	Control Cable	PVC Sheath AWG 16/3 - 32ft			1
3	Gland	Cast Iron	A48M Class30B	EN 1561 GJL-200	2
6	Staffing Box	Cast Iron	A48M Class30B	EN 1561 GJL-200	2
20	Pump Casing	Cast Iron	A48M Class35B	EN 1561 GJL-250	1
21	Impeller	Cast Iron	A48M Class35B	EN 1561 GJL-250	1
22	Suction Cover	Cast Iron	A48M Class35B	EN 1561 GJL-250	1
23	Strainer Stand	Cast Iron	A48M Class30B	EN 1561 GJL-200	1
25	Mechanical Seal	Silicon Carbide / H-60			1
26	Oil Seal	NBR / TC11014014			1
29	Oil Casing	Cast Iron	A48M Class30B	EN 1561 GJL-200	1
30	Oil Lifter	Steel (Cold Rolled)	A109/A1008	EN 10130	1
35A	Oil Plug	Stainless Steel	S 30400	1.4301	2
35B	Oil Plug	Stainless Steel	S 30400	1.4301	2
36	Lubricant	Turbine Oil ISO VG32 or SAE10W-20			
37	Discharge Bend	Cast Iron	A48M Class30B	EN 1561 GJL-200	1
46	Air Valve	Nylon			1
48	Welded Flange	Steel / 8"	A283 Grade D	EN 10025 S275	1
50	Motor Bracket	Cast Iron	A48M Class30B	EN 1561 GJL-200	1
52A	Upper Bearing	#6310ZZC3			1
52B	Lower Bearing	37kW: #6314ZZC3 / 22&45kW: #6315ZZC3			2
53	Motor Protector				3
54	Shaft	Stainless Steel	S 42000	1.4028	1
55	Rotor				1
56	Stator				1
60	Bearing Housing	Cast Iron	A48M Class30B	EN 1561 GJL-200	1
64	Motor Housing	Cast Iron	A48M Class30B	EN 1561 GJL-200	1
71	Shaft Sleeve	Stainless Steel	S 30400	1.4301	1
72	Lifting Lug Bolt	Steel	A283 Grade D	EN 10025 S275	2
90	Leakage Sensor (Electrode)	Stainless Steel			1