

| PARTS LIST |            | VANCS WASTEWATER PUMP                   |      |                           |          | 1/31/2022                     |
|------------|------------|---|------|---------------------------|----------|-------------------------------|
| ITEM       | PART No.   | DESCRIPTION                             | QTY  | SIZE                      | MATERIAL | NOTES                         |
| 1          | 001-471-12 | Cabtyre Cable Set (32') 115V-60Hz (USA) | 1    | VCT3Cx2mm2                | LB       |                               |
|            | 001-000-73 | Cabtyre Cable Set (32') 230V-60Hz (USA) | 1    | STOW3x1.25mm2             | LB       |                               |
| 2          | 143-000-33 | Hex.Tapping Screw                       | 2    | M5x20                     | SUS304   |                               |
| 3          | 003-190-10 | Gland                                   | 1    |                           | SUS316   |                               |
| 4          | 051-000-47 | Head Cover                              | 1    |                           | Resin    |                               |
| 5          | 140-000-07 | Hex.Bolt (w/Plain Washer)               | 4    | M6x30(22L)                | SUS304   |                               |
| 6          | 122-004-18 | O-Ring                                  | 4    | P-6(5.8xd1.9)             | NBR      | *                             |
| 7          | 143-000-33 | Hex.Tapping Screw                       | 2    | M5x20                     | SUS304   |                               |
| 8          | 109-129-19 | Float Support Bush                      | 2    | d14                       | Rubber   |                               |
| 9          | 106-482-14 | Float Set                               | 1Set | AO2-2(350L/400L)          |          |                               |
| 10         | 143-143-15 | Truss Tapping Screw                     | 1    | M4x16(D=8)                | SUS304   |                               |
| 11         | 109-000-01 | Float Support Pipe                      | 1    | VP-14x250L(w/Hole, Black) | VP       |                               |
| 12         | 143-143-15 | Truss Tapping Screw                     | 2    | M4x16(D=8)                | SUS304   |                               |
| 13         | 143-174-15 | Tapping Screw                           | 2    | M4x14                     | SUS304   |                               |
| 14         | 109-000-20 | Holder                                  | 1    |                           | Resin    |                               |
| 15         | 114-000-16 | Power Relay                             | 1    | LY-3F(AC24V)              |          |                               |
| 16         | 143-152-17 | Truss Tapping Screw                     | 2    | M3x8                      | SWCH     |                               |
| 17         | 115-000-11 | Transformer 115V-60Hz(USA)              | 1    | AI120/20-1                | (T)      |                               |
|            | 115-000-13 | Transformer 230V-60Hz(USA)              | 1    | AI230/20-1                | (T)      |                               |
| 18         | 143-152-17 | Truss Tapping Screw                     | 2    | M3x8                      | SWCH     |                               |
| 19         | 143-085-34 | Pan Screw (w/Spring Washer)             | 1    | M4x6                      | C3604    |                               |
| 20         | 009-001-24 | Earth Terminal                          | 1Set | 1.25mm2x195L              |          |                               |
| 21         | 076-000-63 | Capacitor 115V-60Hz(USA)                | 1    | 45MF-220VAC               |          | replaces OLD part# 076-000-01 |
|            | 076-000-70 | Capacitor 220V-60Hz(USA)                | 1    | 12MF-440VAC               |          | replaces OLD part# 076-000-08 |
| 22         | 143-000-05 | Pan Screw                               | 4    | M5x138(20L)               | SWRM     |                               |
| 23         | 053-000-08 | Motor Protector 115V-60Hz(USA)          | 1    | KA142-BDXL14F             | (T+H)    |                               |
|            | 053-000-61 | Motor Protector 230V-60Hz(USA)          | 1    | KA142-BPXL34D             | (T+H)    |                               |
| 24         | 143-136-15 | Truss Screw                             | 2    | M4x10                     | SWRM     |                               |
| 25         | 050-000-02 | Motor Bracket                           | 1    |                           | ADC      |                               |
| 26         | 121-471-17 | Packing                                 | 1    | d126.6xd135.6x6t          | NBR      | *                             |
| 27         | 056-008-17 | Stator (w/M.Frame)115V-60Hz(USA)        | 1Set |                           |          |                               |
|            | 056-008-19 | Stator (w/M.Frame)230V-60Hz(USA)        | 1Set |                           |          |                               |
| 28         | 071-000-01 | Collar                                  | 1    | 37L                       | SECC     |                               |
| 29         | 142-192-16 | Wave Washer                             | 1    | 6201(D=32,t=0.4)          | SK5      |                               |

\* Indicates items included in set

| PARTS LIST |            | VANCS WASTEWATER PUMP           |      |                               | 1/31/2022 |                               |
|------------|------------|---------------------------------|------|-------------------------------|-----------|-------------------------------|
| ITEM       | PART No.   | DESCRIPTION                     | QTY  | SIZE                          | MATERIAL  | NOTES                         |
| 30         | 052-100-15 | Bearing                         | 1    | 6201ZZC3                      |           |                               |
| 31         | 055-000-22 | Rotor                           | 1Set | w/Bearing                     |           |                               |
| 32         | 061-157-15 | Bearing Collar                  | 1    | d15.1xd21x1.6t                | SPCC      |                               |
| 33         | 052-152-12 | Bearing                         | 1    | 6302ZZC3                      |           |                               |
| 34         | 060-001-37 | Bearing Housing                 | 1    |                               | ADC       |                               |
| 35         | 025-000-78 | Mechanical Seal                 | 1    | W-14HL (ROHS)                 | SiC+CCBN  | replaces OLD part# 025-290-19 |
| 36         | 030-000-01 | Oil Lifter                      | 1    | VANCS2                        | Resin     |                               |
| 37         | 121-001-12 | Packing                         | 1    | VANCS2                        | NBR       | *                             |
| 38         | 035-127-15 | Oil Plug                        | 1    | M10x15                        | SUS304    |                               |
| 39         | 121-246-11 | Packing                         | 1    | d10.3xd16x2t                  | PE        | *                             |
| 40         | 140-000-03 | Hex.Bolt (w/Plain Washer)       | 4    | M6x25                         | SUS304    |                               |
| 41         | 029-000-95 | Oil Casing                      | 1    | VANCS2                        | Resin     |                               |
| 42         | 143-000-26 | Truss Screw (w/O-Ring)          | 4    | M6x20(P-5,NBR)                | SUS304    | *                             |
|            | 122-003-17 | O-Ring                          | 4    | P-5(4.8xd1.9)                 | NBR       |                               |
| 43         | 142-354-18 | Conical Spring Washer           | 1    | d11.2xd22.5x0.8t              | SUS304    |                               |
| 44         | 021G2821   | Impeller (60Hz)                 | 1    | 50PNA2.75S-62                 | Resin     |                               |
| 45         | 143-140-12 | Truss Screw (w/Plain Washer)    | 1    | M6x12                         | SUS304    |                               |
| 46         | 122-000-07 | O-Ring                          | 1    | 122xd3.0                      | NBR       | *                             |
| 47         | 140-000-09 | Hex.Bolt (w/Spring Washer)      | 2    | M8x45                         | SUS304    |                               |
| 48         | 048-274-18 | Screwed Flange                  | 1    | NPT-2(P.C.90)                 | Resin     |                               |
| 49         | 121-469-12 | Packing                         | 1    | P.C.90xd58x2t                 | NR        | *                             |
| 50         | 020-000-06 | Pump Casing                     | 1    | (40/50)PN/PSF2.25/.4/.75      | Resin     |                               |
| 51         | 023-000-01 | Strainer                        | 1    | (40/50)PN/TM/TQ2.25/.4/.75    | Resin     |                               |
| 52         | 143-000-10 | Truss Tapping Screw             | 2    | M4x18                         | SUS304    |                               |
|            | 173-000-07 | <b>Packing O-Ring Set</b>       | 1Set | (Marked by *)                 |           |                               |
| 6          | 122-004-18 | O-Ring (Head Cover Fixing Bolt) | 4    | P-6(5.8xd1.9)                 | NBR       | *                             |
| 26         | 121-471-17 | Packing (Head Cover/M.Frame)    | 1    | d126.6xd135.6x6t              | NBR       | *                             |
| 37         | 121-001-12 | Packing (M.Frame/O.Casing)      | 1    | VANCS2                        | NBR       | *                             |
| 39         | 121-246-11 | Packing (Oil Plug)              | 1    | d10.3xd16x2t                  | PE        | *                             |
| 42         | 122-003-17 | O-Ring (P.Casing Bolt)          | 4    | P-5(4.8xd1.9)                 | NBR       | *                             |
| 46         | 122-000-07 | O-Ring (O.Casing/P.Casing)      | 1    | 122xd3.0                      | NBR       | *                             |
| 49         | 121-469-12 | Packing (Screwed Flange)        | 1    | P.C.90xd58x2t                 | NR        | *                             |
|            |            | Lubricant                       |      | Lequid Paraffin VG32<br>240ml |           |                               |

| PARTS LIST |          | VANCS WASTEWATER PUMP |     |      |          | 1/31/2022 |
|------------|----------|-----------------------|-----|------|----------|-----------|
| ITEM       | PART No. | DESCRIPTION           | QTY | SIZE | MATERIAL | NOTES     |

## EXPLODED VIEW

50PNA2.75S-52/62

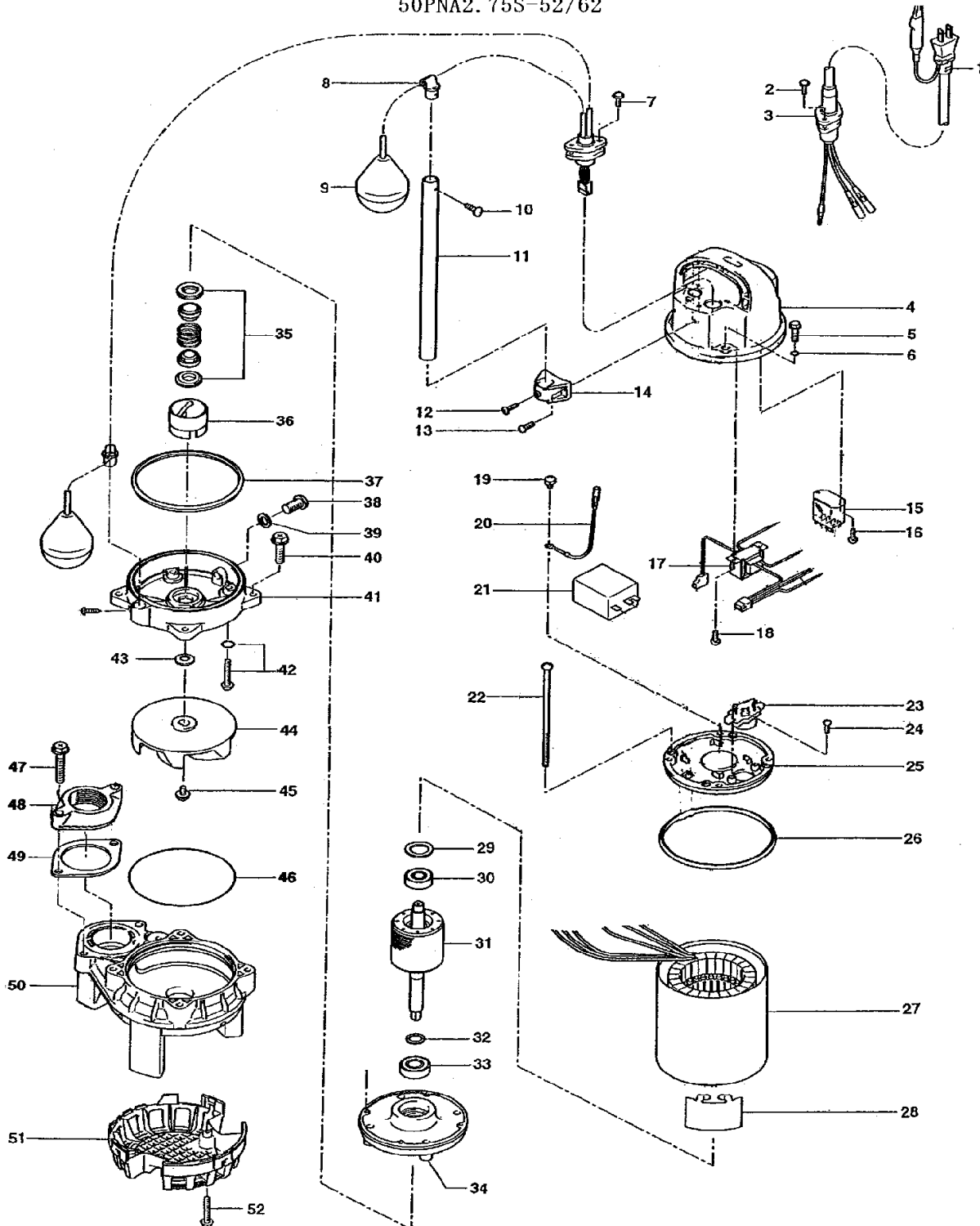

\* Indicates items included in set